

# Solid Fender

## SBP Fender(YSBP)



### Feature

1. Improved from existing Bumper type.
2. Specialized to minimize damages
3. Superior E.A capacity with outstanding compression deformation ratio of the fender body.
4. Can be installed on any curved surface of the bridges.

### Drawing

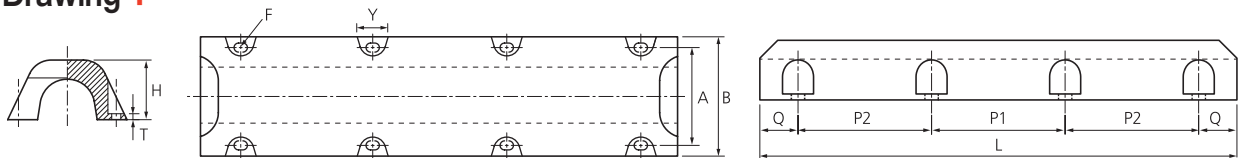

### Performance Curve

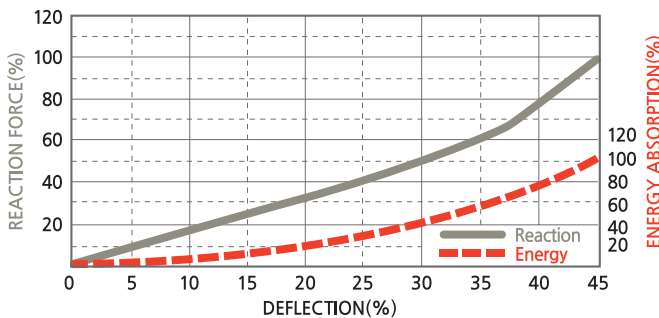

### Performance of Intermediate Deflection

Deflection (%)	0%	5%	10%	15%	20%	25%	30%	35%	40%	45%
Reaction (%)	0%	9%	17%	25%	33%	41%	49%	61%	77%	100%
Energy (%)	0%	1%	5%	11%	19%	29%	42%	57%	76%	100%

### Dimension

Unit : mm

Size Height	F	A	B	T	Y	R		1000L		1500L		2000L		2500L		3000L		
						4°	8°	P2	Q	P2	Q	P2	Q	P2	Q	P1	P2	Q
YSBP 250H	M30(1 1/4")	410	500	25	130	over 3m	under 3m	560	220	560X2	190	560X3	160	700X2	200	700X2	560X2	240
YSBP 300H	M36(1 1/2")	490	600	30	140	over 3m	under 3m	560	220	560X2	190	560X3	160	700X2	200	700X2	560X2	240
YSBP 400H	M36(1 1/2")	660	800	40	140	over 4m	under 4m	560	220	560X2	190	560X3	160	700X2	200	700X2	560X2	240
YSBP 500H	M30(1 3/4")	820	1000	50	170	over 4m	under 4m	560	220	560X2	190	560X3	160	700X2	200	700X2	560X2	240
YSBP 600H	M48(2")	990	1200	60	180	over 5m	under 5m	560	220	560X2	190	560X3	160	700X2	200	700X2	560X2	240

### Performance Table

Size Performance	150(H)	200(H)	250(H)	300(H)	400(H)	500(H)
R·F[kN]	427.3	513.5	684.0	769.3	855.5	1026
E·A[kN·m]	19.4	27.9	49.7	62.9	77.6	111.8

- R · F : Reaction Force[kN]
- E · A : Energy Absorption[kN·m]
- Tolerance : ±5% or ±10%
- Deflection : 45%

[1m Length]